

SENTRIGARD ML 200 24 GA., 18 7/8" WIDE LOAD TABLE OVER 22 GA. STEEL DECK



Buildings having a Roof Mean Height \leq 20'-0"; Roof Slope: 2"/12" -6"/12" Gable or Hip Roof
Wind Speeds 140-180 mph, Exp C, Risk Category II, Enclosed Bldg. based on FLORIDA BUILDING CODE 2010

SENTRIGARD ML 200 24 GA., 18 7/8" WIDE, CLIP SPACING							
ZONE	FASTENER	SUBSTRATE	WIND SPEED ZONE				
			140 ON CENTER SPACING	150 ON CENTER SPACING	160 ON CENTER SPACING	170 ON CENTER SPACING	180 ON CENTER SPACING
ZONE 1	(2) #14-13	22 GA. STEEL DECK	36"	36"	36"	36"	36"
ZONE 2	(2) #14-13	22 GA. STEEL DECK	24"	24"	24"	24"	24"
ZONE 3	(2) #14-13	22 GA. STEEL DECK	6"	6"	6"	6"	6"

- 1) **PANEL DESCRIPTION:** 2" MECHANICAL LOCK, MIN. 24 GA. MSG COATED STEEL, 18 7/8" MAX WIDTH, DOUBLE LOCK SEAM.
- 2) **PANEL FASTENER:** (2) #14-13 DEK FAST PER CLIP.
- 3) **PANEL CLIP:** 2000SNS FLOATING CLIP
- 4) **MAXIMUM ALLOWABLE PANEL UPLIFT PRESSURE:** 54.3 PSF @ 36" O.C., 153.5 PSF @ 6" O.C. PRESSURE BASED ON UL 580/UL 1897 TESTING BY FORCE ENGINEERING TEST REPORT #72-0272T-07A-C.
- 5) **SUBSTRATE:** MIN. 22 GA. STEEL DECK. MUST BE DESIGNED IN ACCORDANCE WITH FBC 2010.
- 6) **PANEL ROLLFORMER:** SCHLEBACH QUADRO-PLUS ROLLFORMER BY METALFORMING, INC.
- 7) **LOAD TABLE BASED ON WIND PRESSURES CALCULATED PER ASCE 7-10 (Kd=0.85) MULTIPLIED BY 0.6 PER FBC 2010, SECTION 1609.1.5.**
- 8) **LOAD TABLE DOES NOT INCLUDE OVERHANG ZONES**

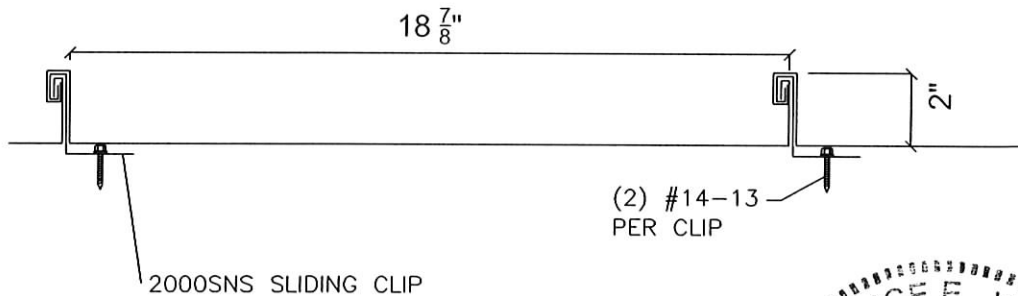

State of Florida
C.O.A.
25778

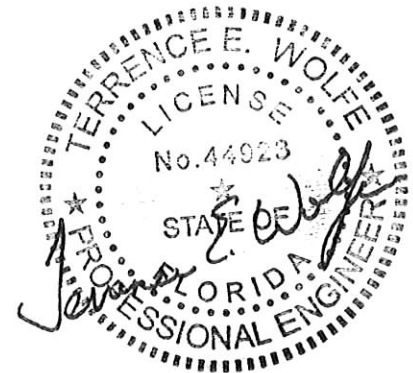

JAN 03 2012

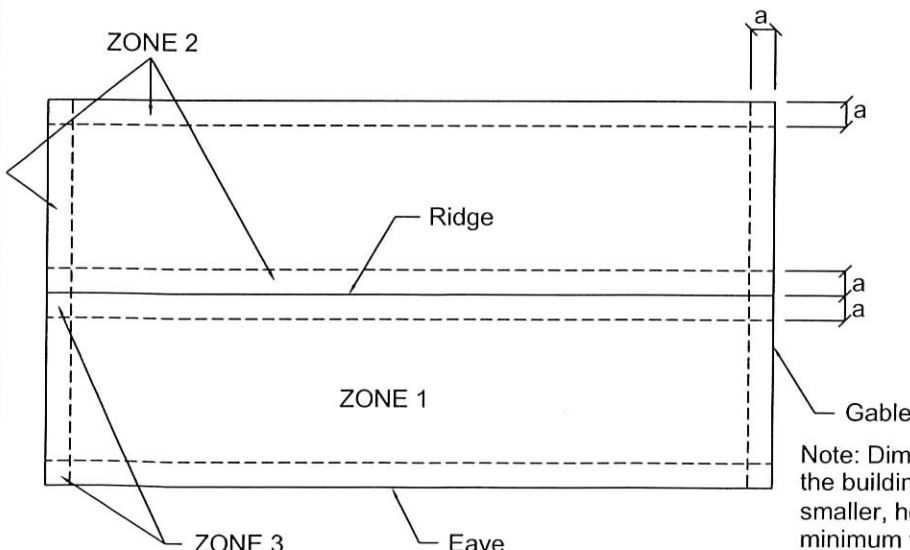

Note: Dimension (a) is defined as 10% of the minimum width of the building or 40% of the mean height of the roof, whichever is smaller, however, (a) cannot be less than either 4% of the minimum width of the building or 3 feet.